

# Split cylindrical roller bearings

single and double row

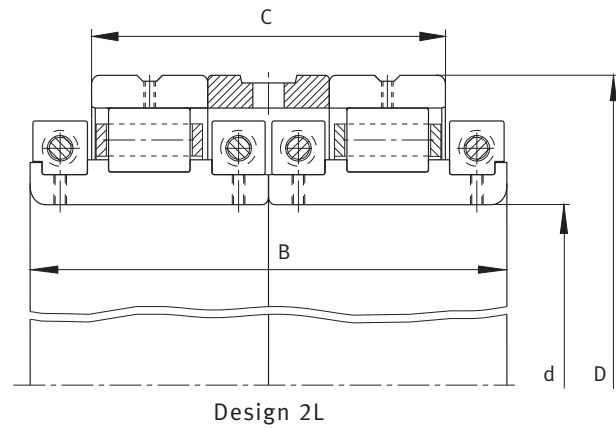
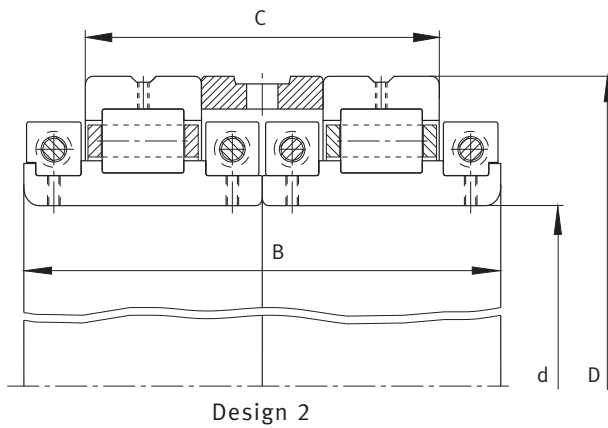

## Split cylindrical roller bearings, $d = 600 - 820$ mm

| Designation <sup>1)</sup> | Design | Mass | Dimensions |     |     |     | Load rating |          |
|---------------------------|--------|------|------------|-----|-----|-----|-------------|----------|
|                           |        |      | m          | d   | D   | B   | C           | dyn.     |
|                           |        | kg   | mm         | mm  | mm  | mm  | $C_r$       | $C_{or}$ |
|                           |        |      |            |     |     |     | kN          | kN       |
| Z-577936.ZL               | 2      | 432  | 600        | 775 | 380 | 278 | 3 250       | 9 000    |
| F-804300.ZL               | 2      | 307  | 600        | 735 | 380 | 278 | 3 000       | 8 800    |
| Z-567618.ZL               | 1      | 200  | 610        | 775 | 190 | 88  | 1 900       | 4 500    |
| Z-572298.ZL               | 1L     | 202  | 610        | 775 | 190 | 100 | 1 900       | 4 500    |
| Z-581300.ZL               | 2      | 425  | 610        | 780 | 380 | 290 | 3 250       | 9 000    |
| Z-526783.02.ZL            | 1L     | 200  | 630        | 794 | 190 | 88  | 1 900       | 4 650    |
| Z-549642.ZL               | 1      | 190  | 630        | 794 | 190 | 88  | 1 900       | 4 650    |
| Z-568614.ZL               | 1      | 209  | 640        | 805 | 190 | 88  | 1 960       | 4 650    |
| Z-574879.ZL               | 2      | 426  | 640        | 805 | 380 | 290 | 3 750       | 11 000   |
| F-568018.ZL               | 2L     | 508  | 650        | 840 | 390 | 300 | 4 400       | 11 800   |
| Z-573047.ZL               | 1      | 694  | 650        | 940 | 320 | 200 | 5 600       | 11 800   |
| Z-573048.ZL               | 1L     | 669  | 650        | 940 | 320 | 200 | 5 600       | 11 800   |
| F-809831.ZL               | 1      | 730  | 650        | 980 | 320 | 200 | 5 600       | 10 400   |
| F-809832.ZL               | 1L     | 709  | 650        | 980 | 320 | 200 | 5 600       | 10 400   |
| F-585320.ZL               | 2      | 538  | 670        | 864 | 390 | 300 | 4 450       | 11 900   |
| Z-526784.01.ZL            | 1L     | 203  | 690        | 864 | 196 | 94  | 2 240       | 5 400    |
| Z-577902.ZL               | 2      | 531  | 690        | 864 | 390 | 284 | 3 550       | 10 200   |
| F-809613.ZL               | 2      | 447  | 710        | 880 | 380 | 290 | 3 900       | 11 400   |
| F-576544.ZL               | 2      | 496  | 710        | 890 | 370 | 280 | 4 150       | 11 600   |
| Z-578276.ZL               | 2      | 551  | 750        | 920 | 400 | 300 | 3 900       | 12 000   |
| F-580174.ZL               | 2      | 626  | 750        | 960 | 380 | 290 | 4 500       | 11 800   |
| F-801623.01.ZL            | 1      | 220  | 775        | 945 | 165 | 80  | 1 830       | 4 550    |
| F-809722.ZL               | 2      | 470  | 775        | 945 | 330 | 245 | 3 150       | 9 200    |
| F-801572.ZL               | 2      | 552  | 820        | 990 | 380 | 290 | 4 300       | 14 000   |

<sup>1)</sup> The bearing design may vary from the above picture – an offer drawing will be provided on request.